

DETAIL C - WINDOW SILL

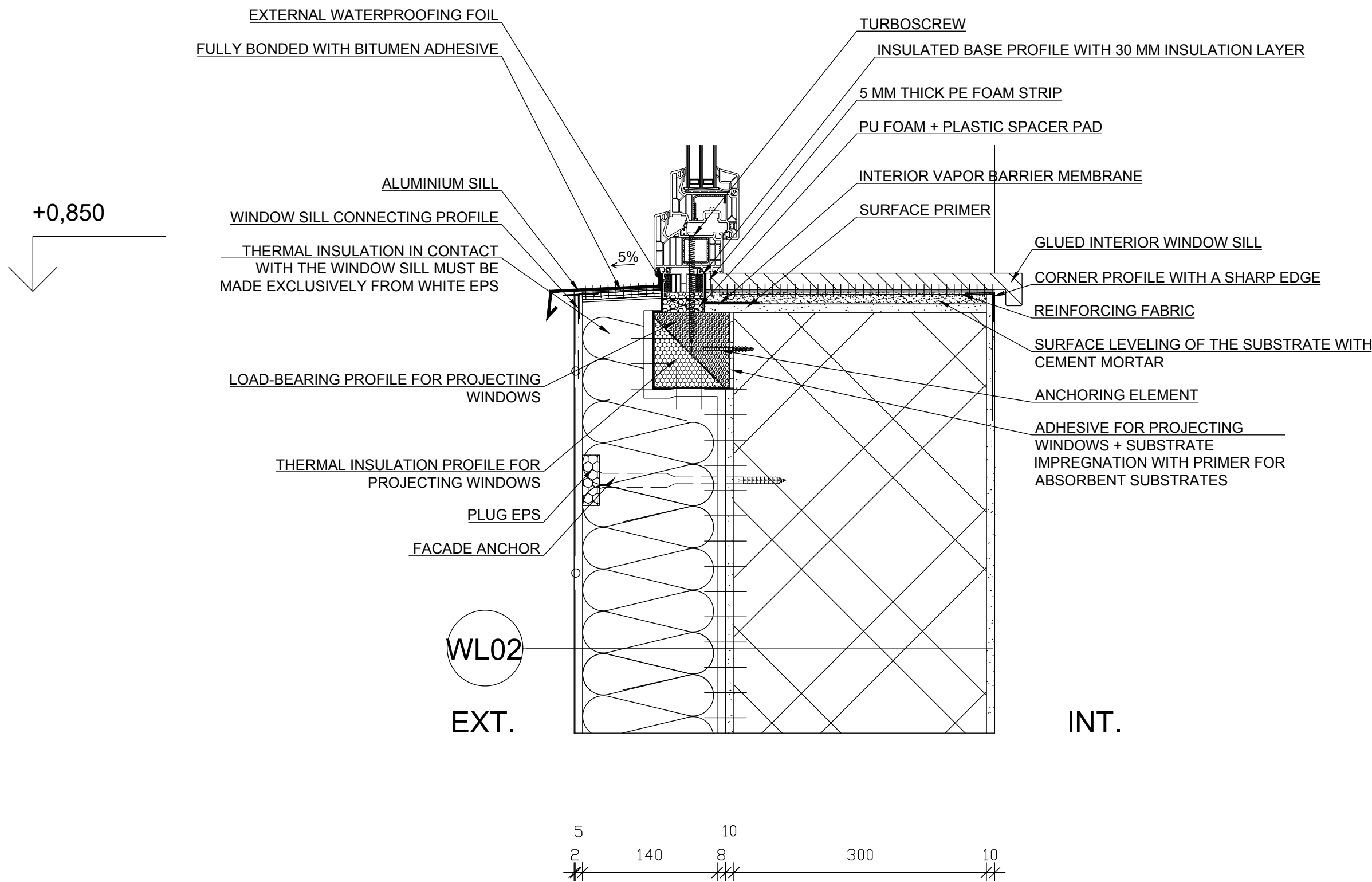

LEGEND OF MATERIALS

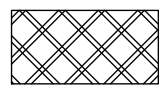

LOAD-BEARING MASONRY – GROUND CERAMIC BLOCK, STRENGTH CLASS P15, GROUND CLAY BLOCK FOR 300 mm

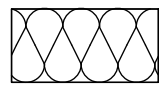

THERMAL INSULATION MADE OF EXPANDED POLYSTYRENE (EPS), THICKNESS ACCORDING TO LAYER COMPOSITION, STRAIGHT EDGE

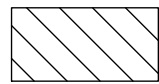

PLASTIC



LOW-EXPANSION PU FOAM

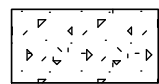

PLASTERS, ADHESIVE COMPOUNDS, DIFFERENT TYPES AND THICKNESS, FOR EXACT SPECIFICARION SEE COMPOSITIONS

<div><div>WL02</div><div>i</div><div>↑</div><div>e</div></div>	INT. WHITE PAINT	
	PRIMER COAT	
	MACHINE-APPLIED GYPSUM PLASTER	10 mm
	CERAMIC BLOCKS	300 mm
	BASE COAT FOR AIR TIGHTNESS	10 mm
	CEMENT-BASED ADHESIVE MORTAR	8 mm
	EPS GREY THERMAL INSULATION	140 mm
	CEMENT-BASED RENDER	5 mm
	BASE PRIMER	
	THIN-LAYER PASTY SILICATE-SILICONE PLASTER	2 mm

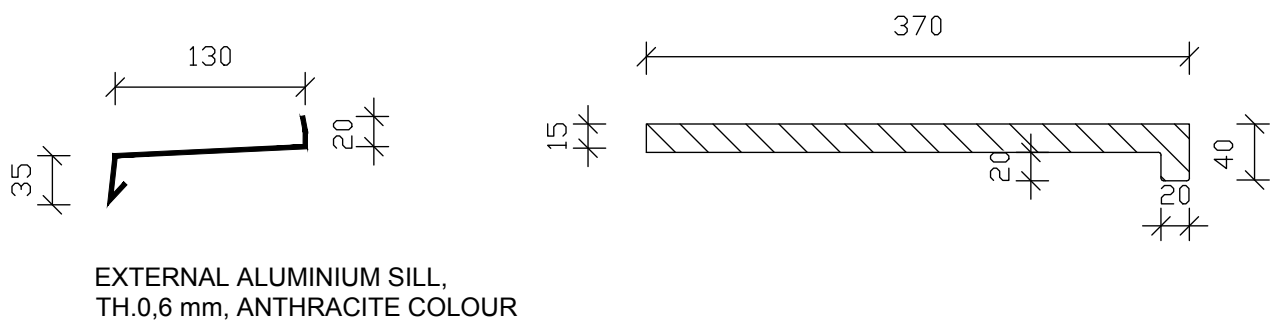

0,000 = 488,307 m.a.s.l.,B.H.S
/ COORDINATE SYSTEM S-JTSK

COURSE	BACHELORS' THESIS	<div><div>T</div><div>FAST</div></div>	
DRAWN BY	ADELA MATUŠOVÁ		
SUPERVISED BY	PROF.ING.JITKA MOHELNÍKOVÁ, PH.D.		
INVESTOR	-		
LOCATION	Krokočín, okres Třebíč, Kraj Vysočina, 595 01, Česko		
PROJECT TITLE	FAMILY HOUSE WITH TATTOO STUDIO	PAPER FORMAT	594x420 (A2)
BUILDING OBJECT	SO 01	DATE	20.5.2025
PART	D.1.1. ARCHITECTURAL BUILDING SOLUTION	PROJ. PHASE	DPS
DRAWING TITLE:	DETAIL C - WINDOW SILL	SCALE	1:5
		DRAWING NO.	D.1.2-12